

Summery— Information

- ☺ **Direct and easy to find**
 - ➔ at the railway line Berlin – Nuremberg, only a few minutes from the railway station
 - ➔ 2 minutes from the B173 major highway
- ☺ **single bed or double bed guest rooms** all newly renovated
- ☺ **all apartments** are spacious, generous in design and comfortable
 - ➔ size between **35m² and 55m²**
 - ➔ towels and bed sheets included
 - ➔ ground level, no stairs and suitable for the less mobile
 - ➔ fully furnished and well appointed
 - ➔ high speed internet connection (broadband)
 - ➔ one/two and more bed apartments
 - ➔ exclusive apartments
 - ➔ design follows Feng-Shui to maximise positive energy
 - ➔ all exclusive apartments have a small work area
- ☺ daily housekeeping and bakery breakfast upon request
- ☺ **privately owned** and managed – for your personal and individual service

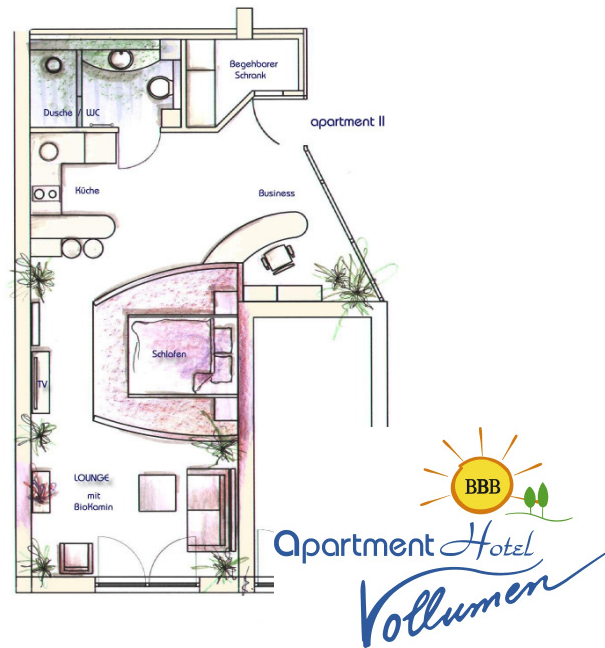

Bahnhofstrasse 44
96257 Redwitz

Telefon: **+49 9574 ~ 65 34 286**
+49 9574 ~ 8404 (Bäckerei Ackermann)
Email: info@vollumen.de
Web: www.vollumen.de

“a warm
welcome”

BBB
Apartment Hotel
Vollumen



96257 Redwitz
Bahnhofstr. 44
neben Bäckerei Ackermann
09574 / 65 34 286 od. 8404

“A warm welcome”



My name is Petra Ackermann and I'm the owner and Managing Director of the Apartment Hotel Vollumen in Redwitz.

I'm very happy to get this opportunity to present you our unique apartments which were developed with a lot of effort, eye for details and a variety of interesting ideas. My long and detailed experience as Feng-Shui and Geomancy Consultant played a major role in the design of our apartments enhancing positive energy flows to make your stay even more pleasant and refreshing. All apartments are designed individually with a generous layout, well thought through with all the amenities you need and completely furnished. You can recharge your batteries, relax and wind down and after a good night sleep start your new exciting day with fresh energy and peace of mind.

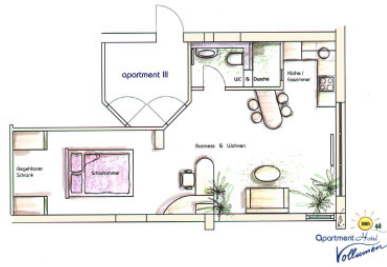

Our **new Hotel & Apartment** building is centrally located in **Redwitz** an der Rodach. For more than 50 years this location is well known as the “Ackermann Bakery” renowned for its tradition, outstanding quality and best quality produce not only in the master bakery but for many years also for friendly, well appointed guest rooms and excellent service.

Redwitz, in the heart of **Upper Franconia** lays at the crossroads between the famous castle-town Coburg, the German Beer Capital Kulmbach, the Wagner-Town Bayreuth and Bamberg with its Cathedrals as well as Kronach, home town of the famous painter Lucas Cranach. Redwitz is ideally located at the foothills of the Fichtelgebirge, it is within a short distance of the B173 Highway if you come by car, or, if you prefer the train, Redwitz is directly at the railway line from Nuremberg (Lichtenfels) to (Kronach) Berlin.

As a **tourist** you can plan a lot of small and easy excursions, whether cultural or exploring our beautiful nature. There are a lot of opportunities, whether going to the city of Nuremberg, have a trip to the Fichtelgebirge, go via the “Rennsteig” to Erfurt/Weimar or travel through the Vogtland County to Leip-



zig – there are endless opportunities, whether by car, by train or on foot.

You will find our well appointed and modern apartments directly next to the Ackermann Bakery in Bahnhofstrasse 44, 96257 Redwitz. They are ideally located only a short walk to the industrial estate “Am Bahnhof”, a short walk to the train station and directly at many idyllic and attractive hiking trails.

We offer you **unique solutions** for you stay in the region whether **private or business**, solutions and quality you'll find nowhere else.

I wish you a relaxing stay with us and a very warm welcome again.

Yours

Petra Ackermann

